

LED ENCLOSURE LAMP

LED 025 | 02541.0-03



Compact LED enclosure lamp. Electrical connection via male connector with snap lock. High service life of the switch cabinet lamp (LED) of 60,000 hours. Mounting by magnet, clip or screw fixing. Luminaire body can be rotated through 180°, angle of radiation 120° for optimum illumination.

- Switching options: PIR motion detector, on/off switch
- Wide-range voltage
- Luminous flux 400 Lm
- Luminous color: 6000 to 7000 K (daylight white)
- Daisy chain



OVERVIEW TECHNICAL DATA

Device type	LED enclosure lamps
Switch	Motion detector
Illuminant	LED
Protection class	II
Protection type	IP20
Casing	Plastic, transparent
AC/DC	AC
Operating voltage	100 V - 240 V
Frequency	50;60 Hz
Power consumption	<4 W
Luminous colour	6000 - 7000 K
Luminous flux	400 Lm
Service life	>60000 h
Operating temperature	-40 °C - 60 °C
Operating humidity	≤90 % RH
Storage humidity	≤90 % RH
Storage temperature	-40 °C - 85 °C
Connection type	Connector plug
Connection	2-pole connector with snap lock
Mounting	Clip
Height	47,3 mm
Width	40 mm
Depth	351 mm
Weight	200 g
Item number accessories 1	244359

Item number accessories 2	244357
Item number accessories 3	264057
Item number accessories 4	264058
Accessory 1	Extension cable 2 x AWG 16 with female and male connectors - through-wiring, 1 m
Accessory 2	Connection cable 2 x AWG 16 with female connector, 2 m
Accessory 3	Separate female connector for cable connection
Accessory 4	Separate male connector for cable connection
Note	The light must not be used for household lighting.
CCC	CCC approved

CONNECTION CABLE WITH FEMALE CONNECTOR AND OPEN END

Article number	usage	color	AC/DC	design	Depth
244356	for entrance side	Female connector: white Cable: white	AC	Connection cable 2 x 1.5 mm ² with female connector	2000 mm
244357	for entrance side	Female connector: white Cable: white	AC	Connection cable 2 x AWG 15 with female connector	2000 mm
244360	for entrance side	Female connector: white Cable: white	DC	Connection cable 2 x 0.75 mm ² with female connector	2000 mm
244361	for entrance side	Female connector: white Cable: white	AC	Connection cable 2 x AWG 15 with female connector	2000 mm

EXTENSION CABLE WITH FEMALE AND MALE CONNECTORS FOR DAISY CHAIN WIRING

Article number	usage	color	AC/DC	design	Depth
244358	Daisy chain	Female/male connectors: white Cable: white	DC	Extension cable 2 x 1.5 mm ² with female and male connectors	1000 mm
244359	Daisy chain	Female/male connectors: white Cable: white	DC	Extension cable 2 x AWG 16 with female and male connectors	1000 mm
244362	Daisy chain	Female/male connectors: white Cable: white	DC	Extension cable 2 x 1.5 mm ² with female and male connectors	1000 mm
244363	Daisy chain	Female/male connectors: white Cable: white	DC	Extension cable 2 x AWG 15 with female and male connectors	1000 mm

FEMALE/MALE CONNECTORS

Article number	usage	color	AC/DC	design	cable_cross_section
264057	for entrance side	white	AC	Female connector	0.5-2.5 mm ² (AWG 14-20)
264058	for output side	white	AC	Male connector	0.5-2.5 mm ² (AWG 14-20)
264059	for entrance side	blue	DC	Female connector	0.5-2.5 mm ² (AWG 14-20)
264060	for output side	blue	DC	Male connector	0.5-2.5 mm ² (AWG 14-20)

TECHNICAL DRAWINGS

Cable accessories



1 Connection cable, Art. No. 244356



2 Extension cable, Art. No. 244358

Connector accessories



Female connector, Art. No. 264057



Male connector, Art. No. 264058

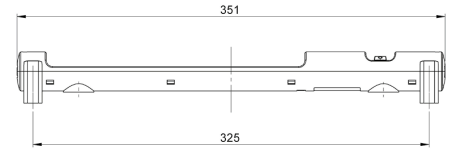

LED 025 with clip fixing

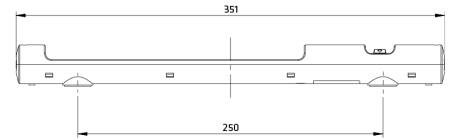

LED 025 with magnet or screw fixing

Side view magnet fixing

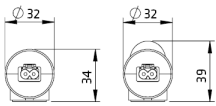

Side view screw fixing

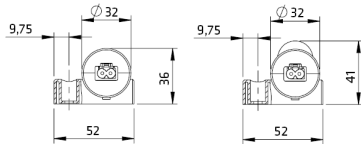

Side view clip fixing

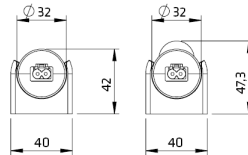

Connection example

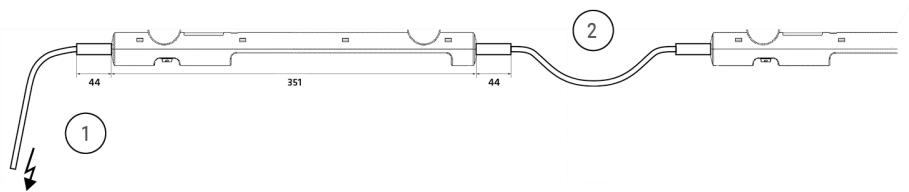

LED 025 lamp with connector in a daisy-chain application. Up to 10 lamps can be connected via quick connection plugs. Snap-lock connectors ensure a stable electrical connection, even under heavy vibration. The example shows an AC 230 V application using a connection cable with female connector, Art. No. 244356 (1), and a daisy-chain extension cable with two connectors, Art. No. 244358 (2).

Female/male connectors are also available to assemble cables in non-standard lengths.